



Addendum #02

Issued: Friday, April 26, 2024

Project Number: 2020-403
 Project Name: DSHS – Western State Hospital – New Forensic Hospital: Owner Representative (Construction Management) Services
 Project Location: Lakewood
 Phase: Request for Qualifications
 Project Manager: Aarón Martínez, aaron.martinez@dshs.wa.gov

NOTICE TO ALL POTENTIAL RESPONDENTS

The Request for Qualifications (RFQ) is modified as set forth in this Addendum. The original RFQ documents and any previously issued addenda remain in full force and effect, except as modified by this addendum, which is hereby made part of the RFQ. Respondent shall take this Addendum into consideration when preparing and submitting its Statement of Qualification.

Visit our webpage for additional information: <https://des.wa.gov/services/facilities-and-leasing-management/architecture-engineering-design-consultants/current-projects-advertised-consultant-selection>

1. The following are changes to the procurement requirements:

Reference Section	Change
Submittal Requirements (page 4)	Document clarification. Remove Federal SF 330 form as part of requirements.

2. Attachments

- Informational Meeting Sign-in Sheet
- Clark Construction Slide show

This addendum does not amend the due date or time for submission of Statements of Qualifications.

End of Addendum #02

Name	Company	Phone Number	Email
JOHN ZACHARA	IFS	847-714-7481	jzachara@ifspm.com
JACOB COONEY	SENECA GROUP	206-549-1153	jacdoc@senecagroup.com
Kayla Van Lieshout	KIOSH GROUP	425 428 8575	Kayla@kioshgroup.com
Abram Jenks	Kiosh Group	503-729-0566	Abram@kioshgroup.com
JAMES McREYNOLDS	SENECA GROUP	206-396-8012	JAMESM@SENECAGROUP.COM
PALE Knykendall	WENATA GROUP	503-837-4178	PALEK@WENATAGROUP.COM
Brent Wilcox	OAC Services	206-305-0385	bwilcox@oacsvs.com
MELISSA TEICHMAN	OAC SERVICES	206-459-0584	MTEICHMAN@OACSVCS.COM
Cicely Stewart	knit	253-457-9258	CicelyS@knitstudios.com
Kimberly McHugh	Cumming Group	253-579-6050	Kmchugh@cumming-group.com
BHAVIK RAO	URBANCRAFT	206 425-241-8990	bhavik@urbancraftconsulting.com
JEFF GLANDER	SCJ	410-951-5130	JEFF-GLANDER@SCJALLIANCE.COM
DAVID STOKES	TURNER-TOWNSEND	804 245 4547	david.stokes@TURNTOWN.COM
Douglas Lovitt	Project Planning Partners	425-877-6800	doug@projectplanningpartners.com
Arthur Antoine	Axiom Consulting & Project Management	917-645-2095	arthur.antoine@axiomppm.com

Western State Hospital – New Forensic Hospital



Campus History

1889 Fort Steilacoom Asylum



1900 – Original Ward



1920 – Front of Campus



1923 – Campus Gate



1923 – Aerial Site Photo

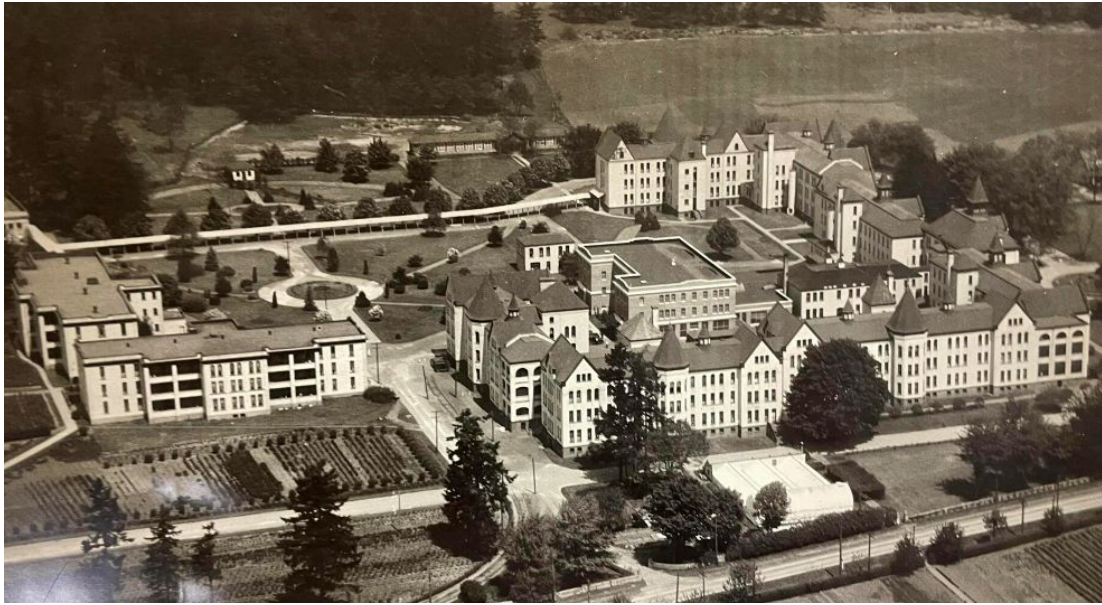

1948 – Building 27



1975 Campus Aerial

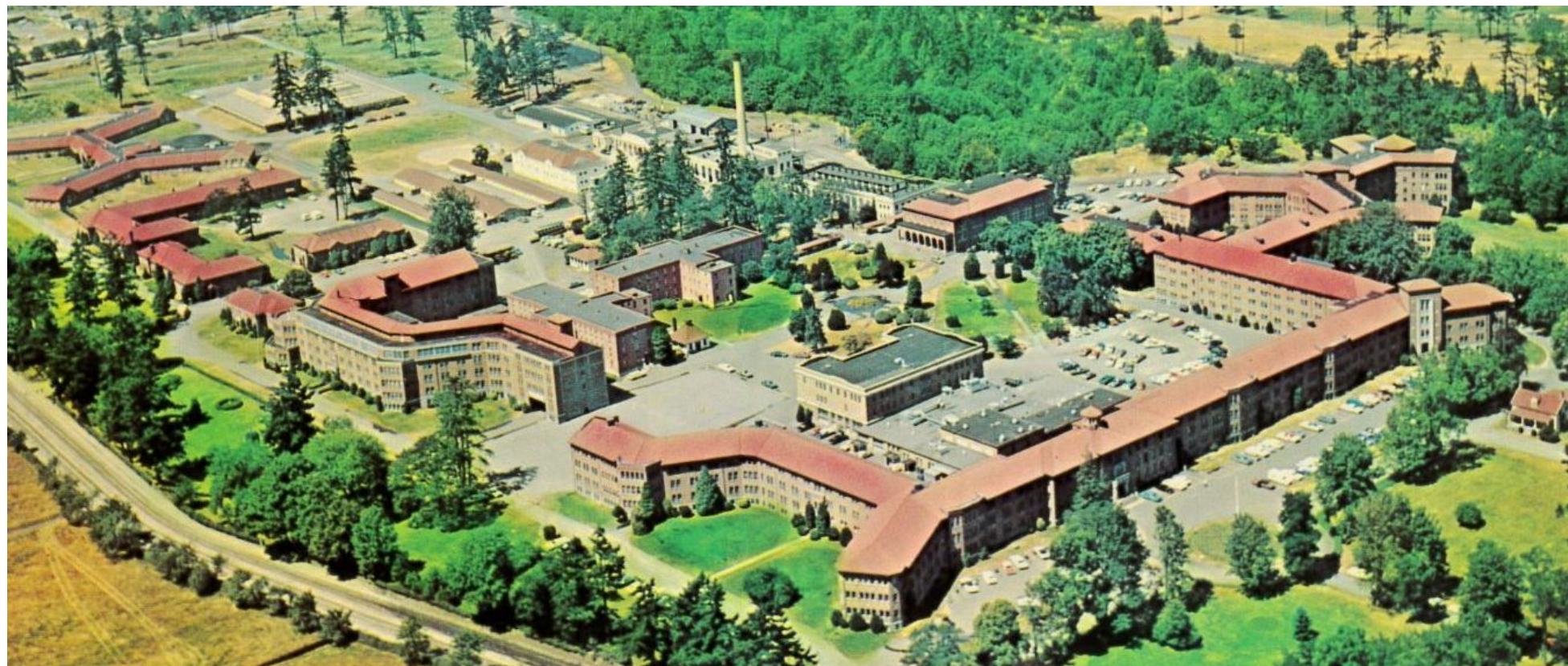

2023 Campus Aerial





Timeline of Events

- Make Ready (Enabling) Projects – **Ongoing through Q4 2024**
- Demo + Abatement – **Ongoing through Q3 2024**
- Foundations + Structure begin – **Q4 2024/Q1 2025**
- Enclosure begins – **Q4 2025**
- Interior Finishes Begins – **Q2 2026**
- Perm. Power – **Q2 2026**
- Commissioning, Testing, Start-up – **Q1 2027**
- TCO/Substantial Completion – **Q4 2027/Q1 2025**

Key Stakeholders:

CLIENT :



GC/CM:



ARCHITECT:



ASSOCIATE ARCHITECT:



MEP ENGINEER:



CIVIL/STRUCTURE ENG:



Project Information



Forensic Hospital

- 467,705 square foot – 4 story building
- 350 patient beds
- Space requirements
 - Basement/Tunnel
 - Anti-ligature
 - High security
 - Differing risk categories

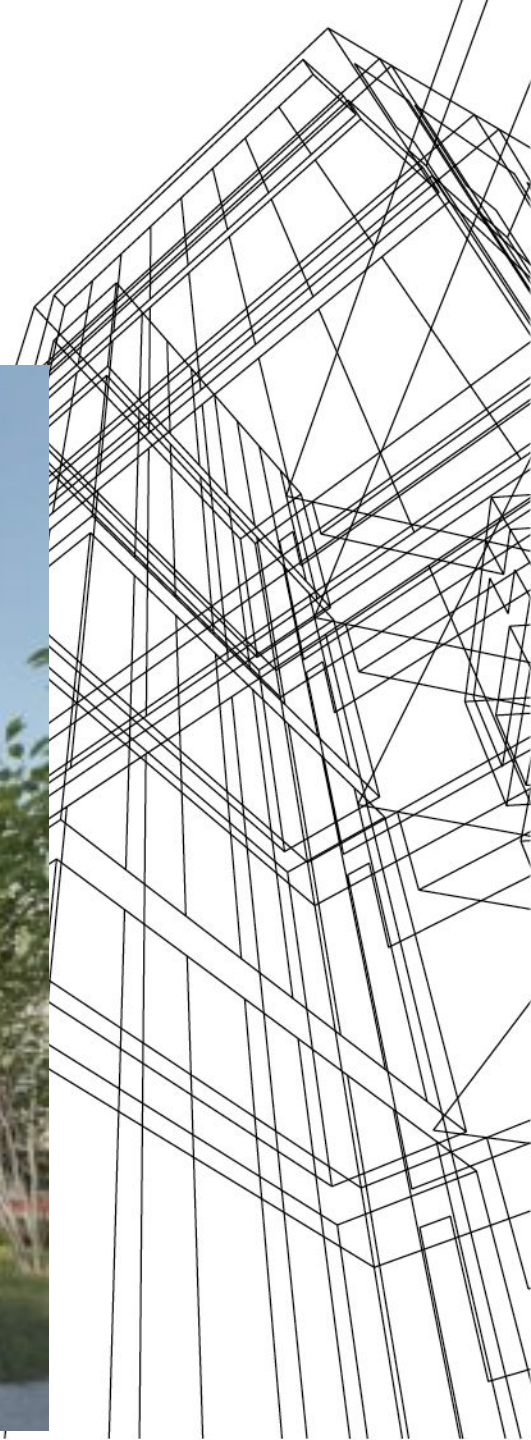

Forensic Hospital Construction

- 4 Story post tension structure
- Interconnecting steel bridges
- Basement/Tunnel

Envelope

- Panelized rainscreen
- Veil
- Masonry

Net Zero Provisions

LEED Silver



Administration Building

- 55,247 square foot – 3 story building
- 1,010 Staff members
- Mass Timber Structure

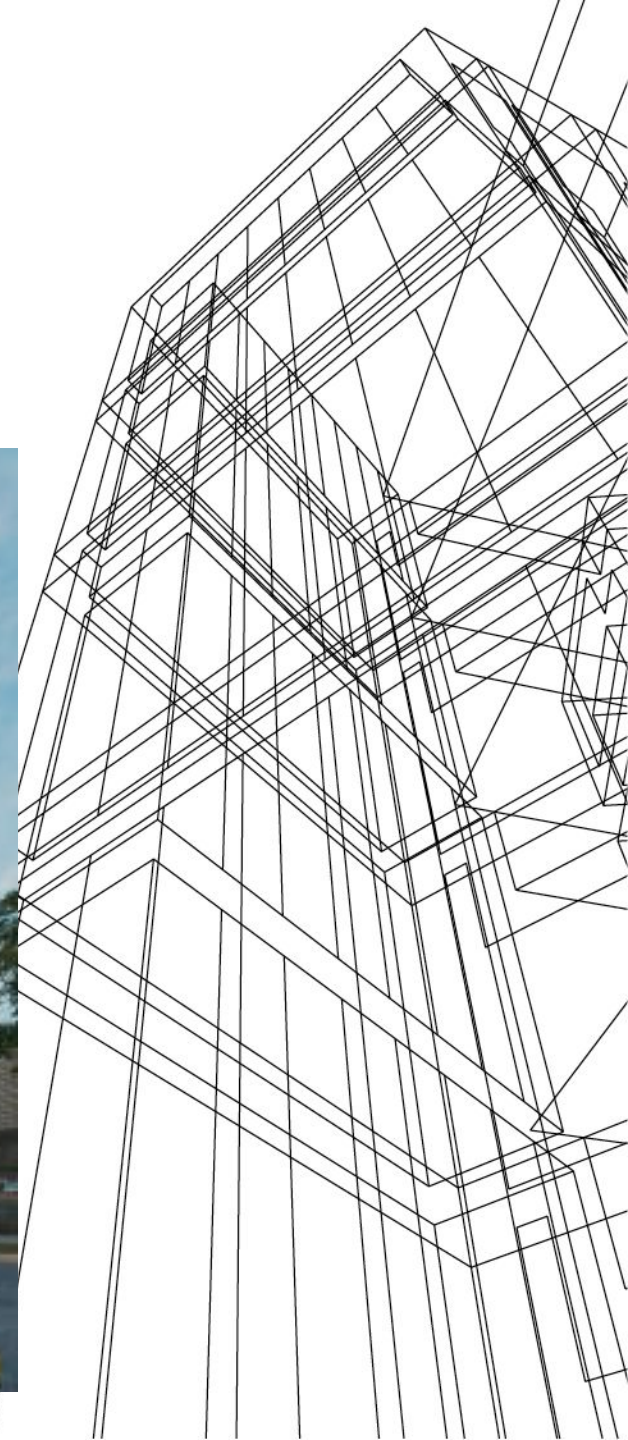

Site and Landscaping

- Over 30 acres of improvements
- Approximately 600 new parking spaces
- Over 900 trees to be planted
- Existing and abandoned utilities





Construction and Logistics



Logistics

Building/Utility Demo

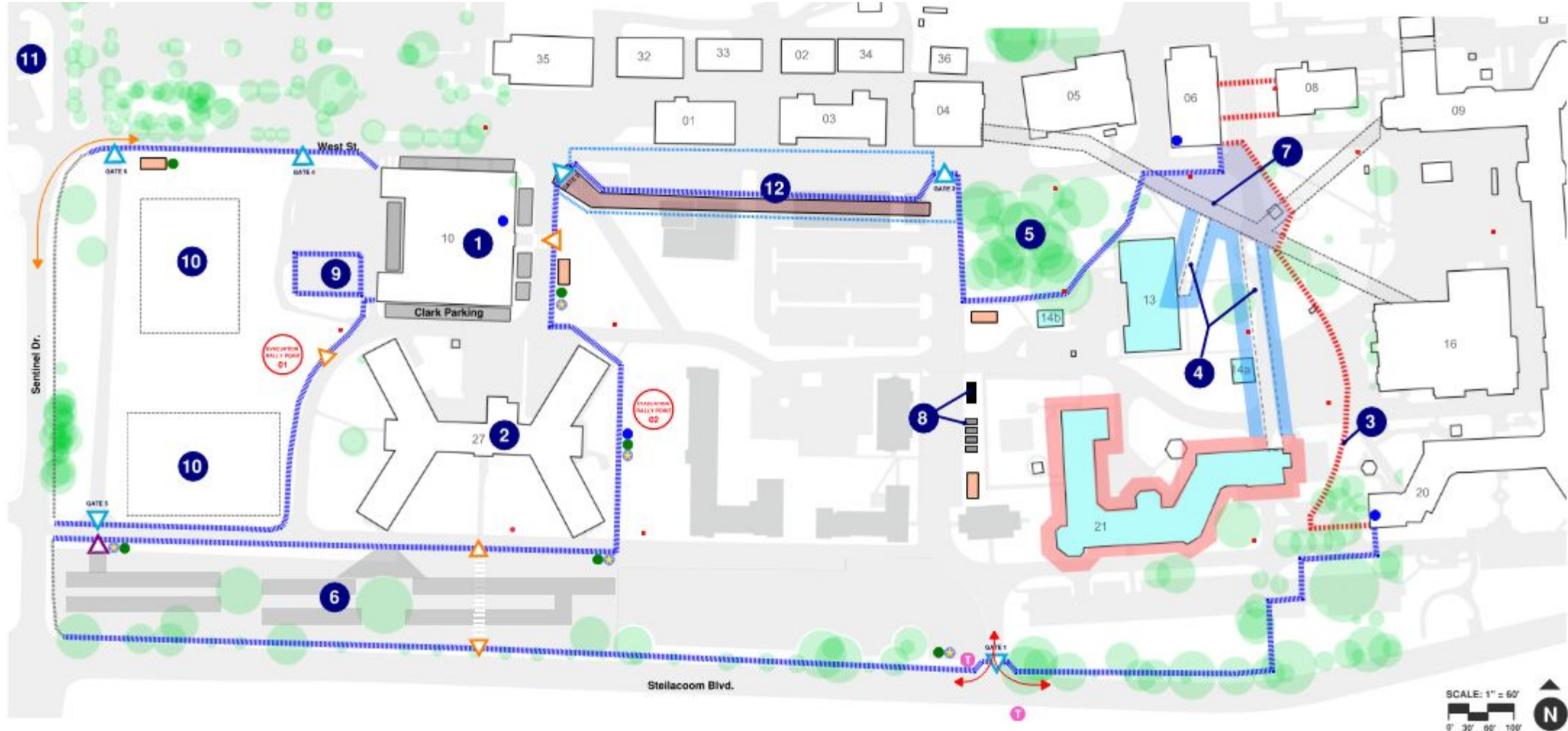

Logistics

Foundations

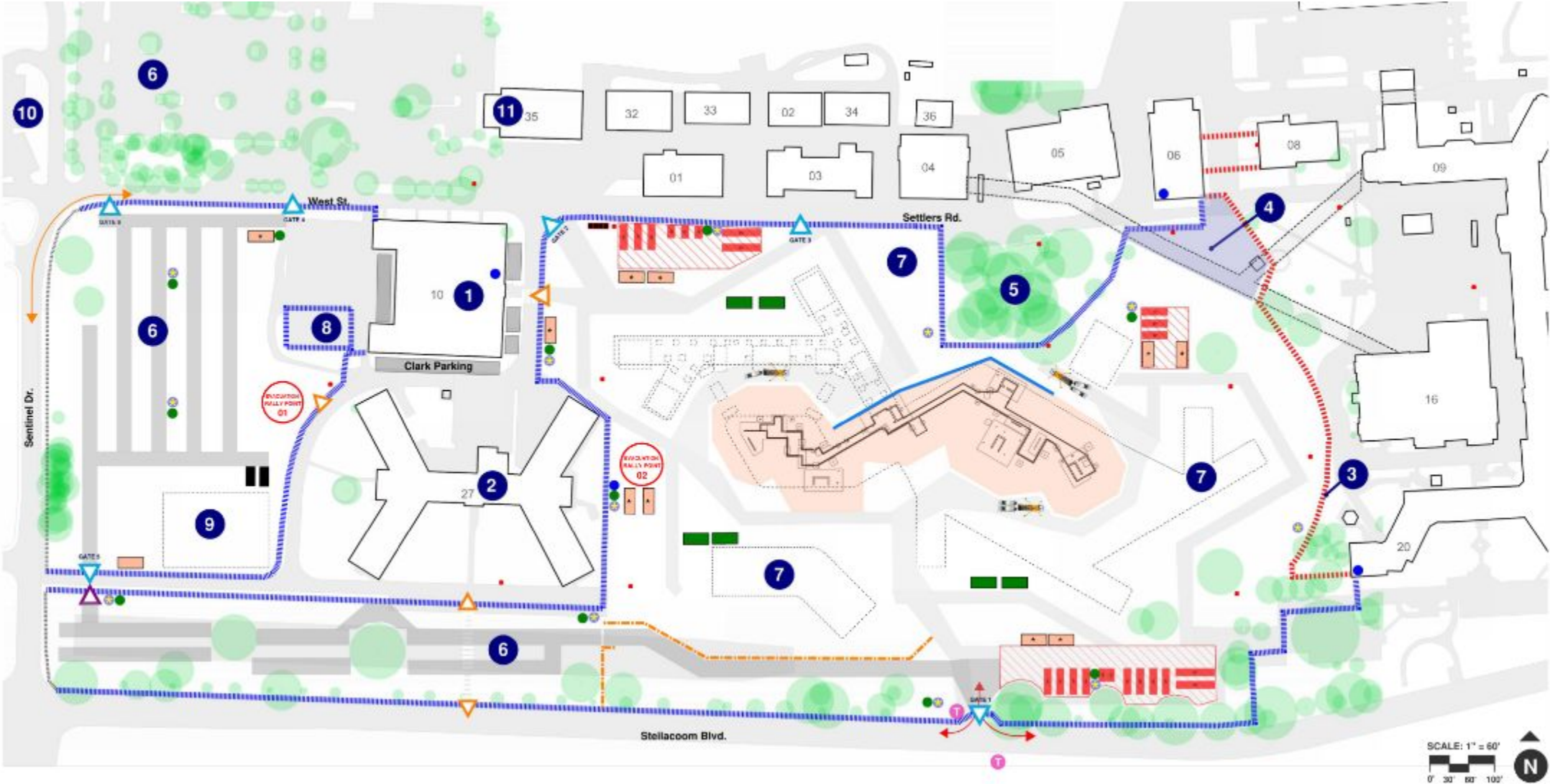

Logistics

New Forensic Hospital



Questions?

An abstract geometric pattern of white wireframe lines on a blue background, consisting of numerous overlapping, tilted rectangular and polygonal shapes that create a sense of depth and complexity.